

ACADEMY

HOBBY MODEL KITS

TA980



미육군 자주포 전차 M-18 헬캣

1/35 SCALE

M-18 HELLCAT

U.S. ARMY GUN MOTOR CARRIAGE

【 TECHNICAL SPECIFICATION 】

CREW : 5 men

DIMENSIONS

*Length overall : 262 in.

*Hull length : 214 in.

*Width : 113 in.

*Height: 101½ in.

*Clearance : 14¼ in.

WEIGHT

*Loaded : 37,557 pdrs.

*Empty : 35,526 pdrs.

GROUND PRESSURE : 11.9p.s.i.

ARMOR*

*Turret Front : 1 in.

*Turret Sides & Rear : ½ in.

*Hull front, Sides, Rear : ½ in.

*Hull Top : ⅓ in.

*Hull Floor : ¼ in.

ARMAMENT

*1×76mm M1/M1A1 Gun/

*1×12.7mm Cal.50 MG

AMMUNITION : 45 / 840 rounds

PERFORMANCE

*Max speed : 55 miles/h

*Trench crossing : 74 in.

*Fording depth : 48 in.

*Max gradient : 60 %

*Range : 105 miles

*Turning radius : 33 ft.

TRACK : T-69 Steel 14.38 in.,

Pitch 5.11 in.

SUSPENSION

*Torsion bar

*Road wheels 26 in.×4½ in.

ENGINE

Continental R-975 C1 340hp

/C4 400hp 9cylinder aircooled

TRANSMISSION : Torqmatic 3FIR

FUEL : 170 U.S.gallons

PRODUCTION

A Total of 2,507 vehicles in July
1943 until March 1945.

【 성능 및 제원 】

승무원 : 5명

길 이

*전장 : 665.48 cm

*차체장 : 543.56 cm

*전폭 : 287.02 cm

*전고 : 257.65 cm

*지상고 : 36.2 cm

중 량

*전투 중량 : 17톤

*차체 중량 : 16.1톤

접지압 : 0.83 kg/cm²

장 갑

*포탑 전면 : 2.54 cm

*포탑 측,후면 : 1.27 cm

*차체 전,측,후면 : 1.27 cm

*차체 상면 : 0.8 cm

*차체 하면 : 0.64 cm

무 장

*7.5 cm M1/M1A1 주포 1문/

*1.27 cm Cal.50 기관총 1정

탄 약 : 포탄45 / 기총탄840발

기동성

*최대 속도 : 88 km/h

*초호(超壕) 반경 : 188 cm

*도하 수심 : 122 cm

*행동 거리 : 168 km

*선회 반경 : 1000 cm

캐터필러 : T-69 철제 36.5 cm,

피치 12.9 cm

서스펜션

*토션 바 식

*전륜 66.04 cm×11.43 cm

엔 진

콘티넨탈 R-975 C1 340마력

/C4 400마력 9기통 공냉식

트랜스미션 : 토오크매틱 3FIR

연료적재량 : 643.45 리터

생 산

1943년 7월부터 1945년 3월

까지 총 2,507대 생산.

#1375

■ 조립하기전

- 제품을 조립하기전에 설명서를 끝까지 잘 읽어본다.
- 부품을 자를때에는 칼이나 니퍼로 깨끗이 잘라준다.
- 접착하기전에 부품을 맞추어 확인한 후 접착한다.
- 접착제를 사용할 곳과 사용하지않는 곳에 주의하고 너무 많이 바르지 않도록 한다.
- 에나멜 페인트나 접착제를 사용할때에는 창문을 열어 환기를 시키고 화기를 멀리한다.

- 직매점 겸 A/S센터 : 삼선교:742-9293, 대치동:552-9293, 양재동:575-9997, 용산:706-9293
- A/S 센터 : 본사:908-7000 (교환 147), 동대문:745-9293, 천호동:473-9293
- 총판점 겸 A/S센터 : 노원아카데미:907-0940, 양천아카데미:691-7108, 강남아카데미:522-1577, 강북아카데미:762-0980, 경기가카데미:(0343)458-5591, 부산아카데미:(051)293-7449, 대구아카데미:(053)744-9293
- ◆ 고객센터 문의 : 080-969-7000
- 홈페이지 - <http://www.academy.co.kr>
<http://www.academyhobby.com>

1

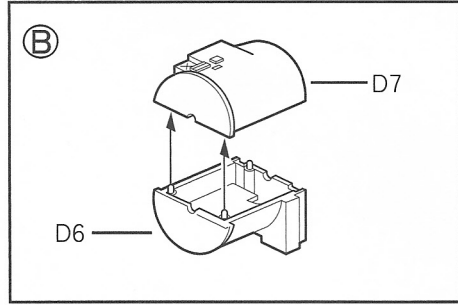
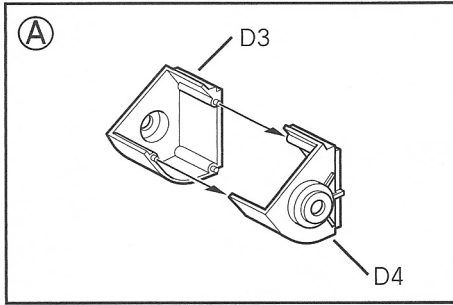

→ 접착한다. CEMENT ●---→ 접착금지. DO NOT CEMENT
※ () 는 반대측 부품 번호임. () is opposite number.

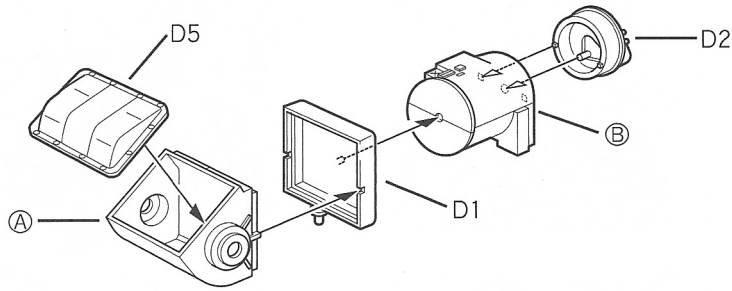

▶무광백색 Flat White

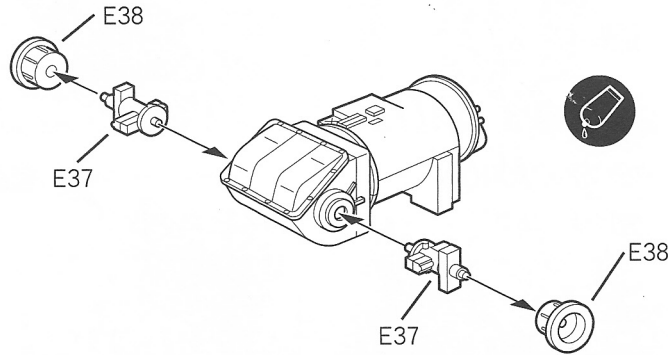

2

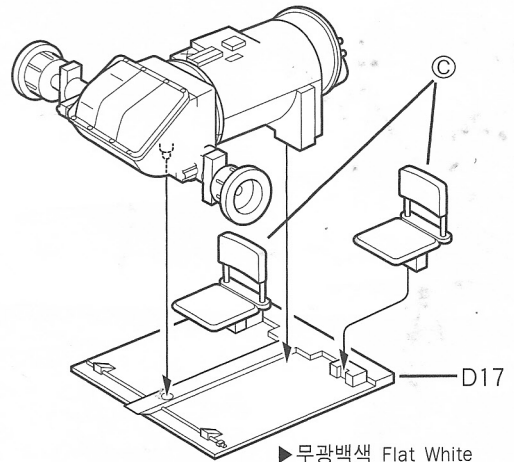
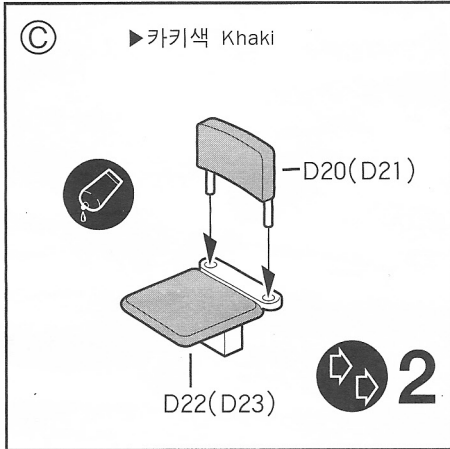

▶무광백색 Flat White

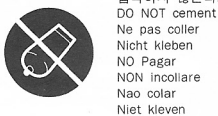

3

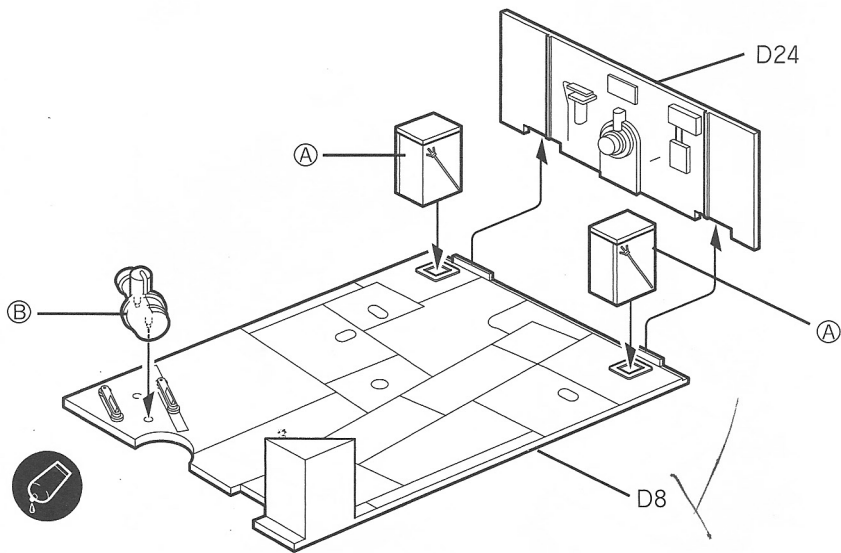
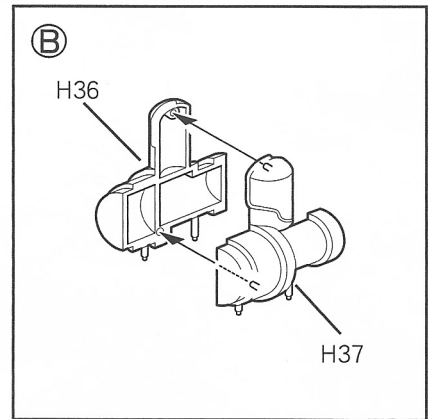
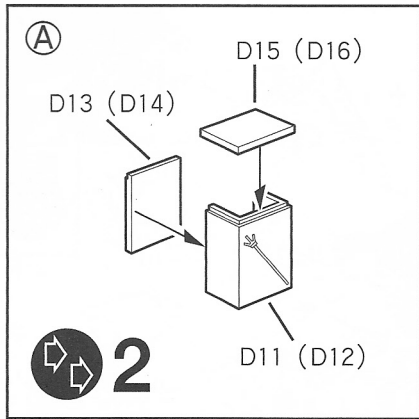

4

▶ 차체 내부색 Hull Interior
 전체 무광백색 Overall Flat White

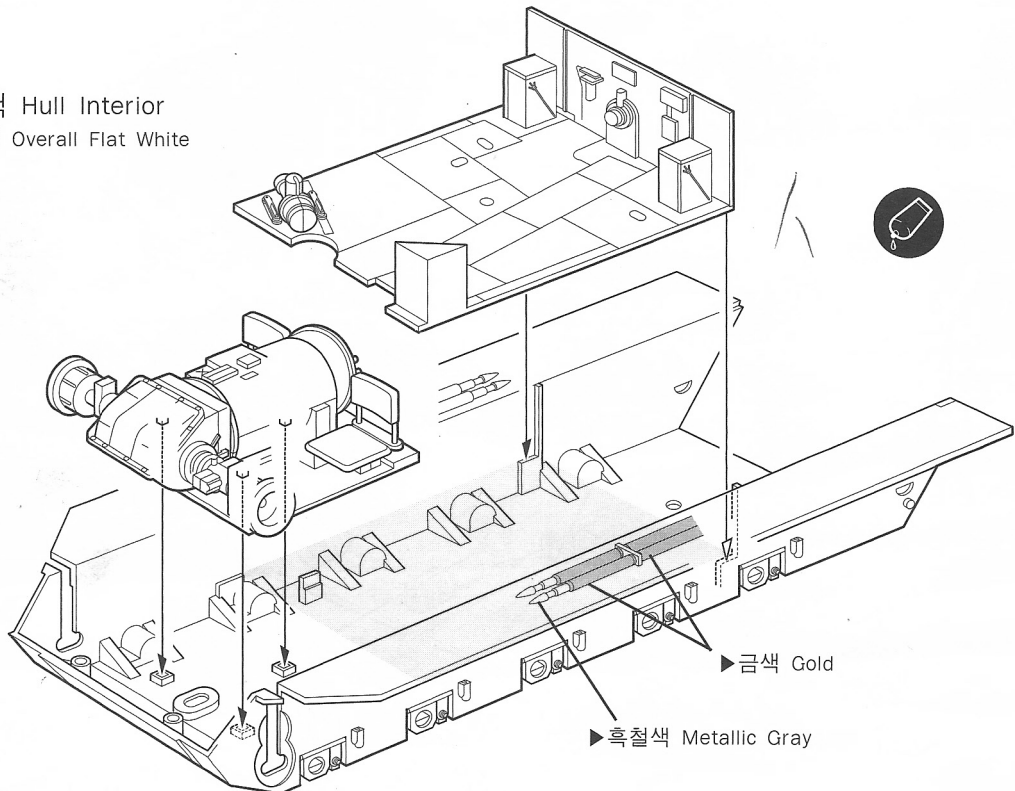

5

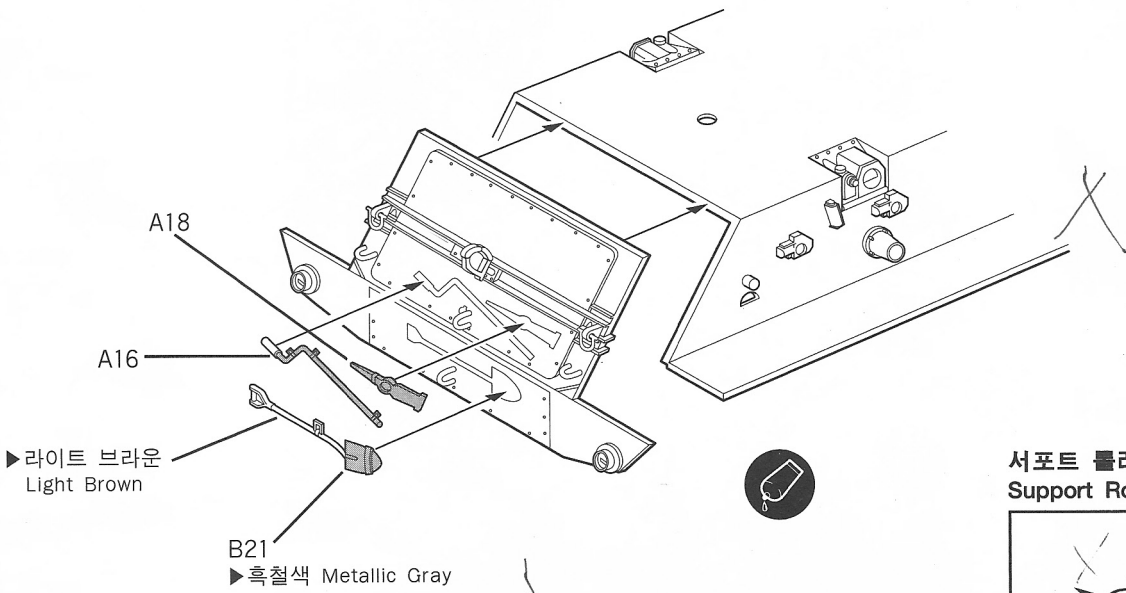
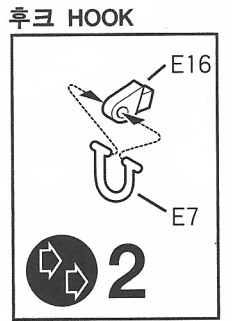
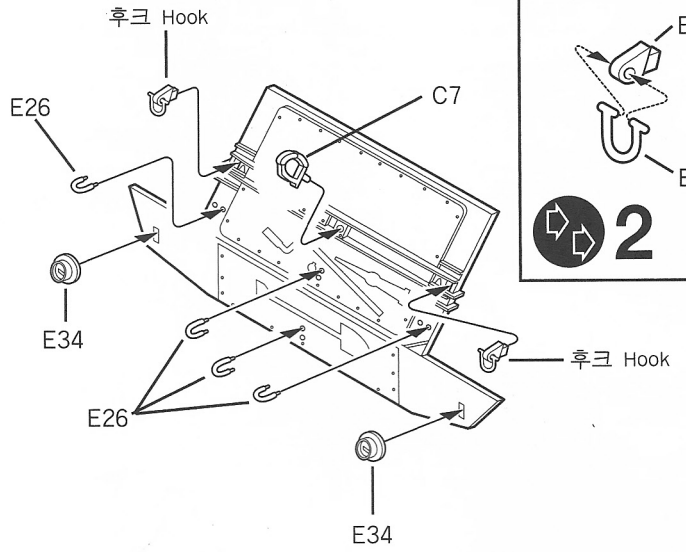
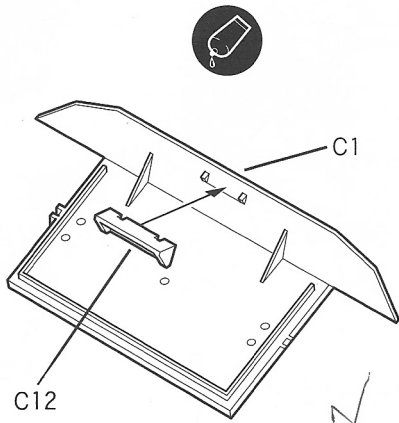

서포트 롤러 Support Roller

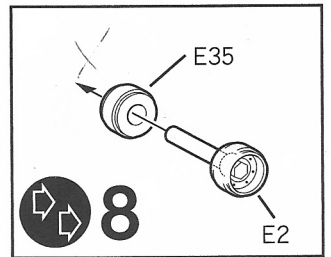

6

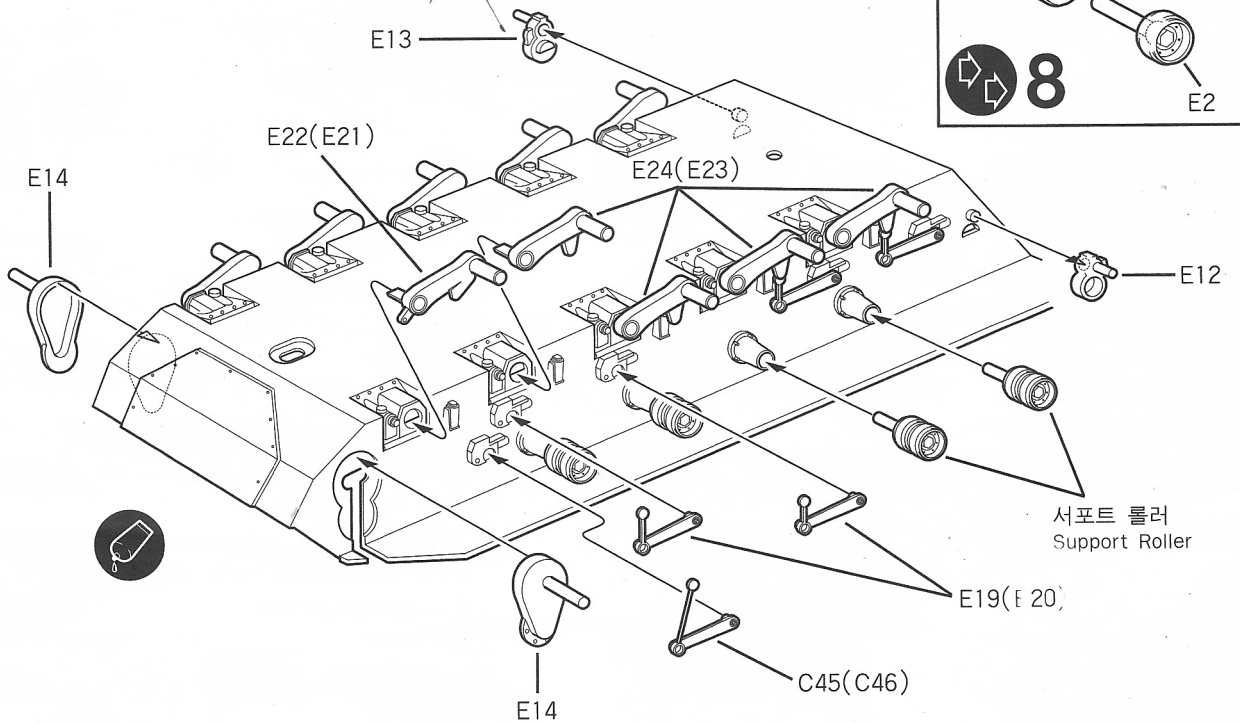

서포트 롤러 Support Roller

7

Ⓐ 전륜 Road Wheel

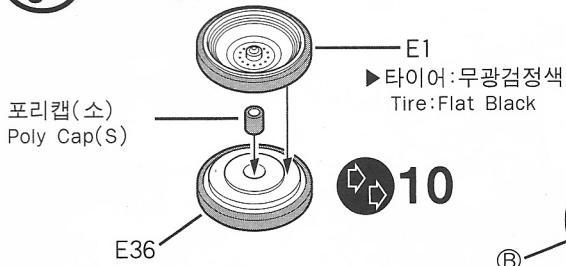

Ⓑ 아이들러휠 Idler Wheel

2

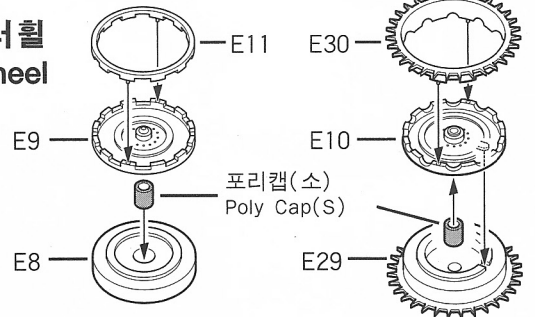

Ⓒ 기동륜 Drive Sprocket

2

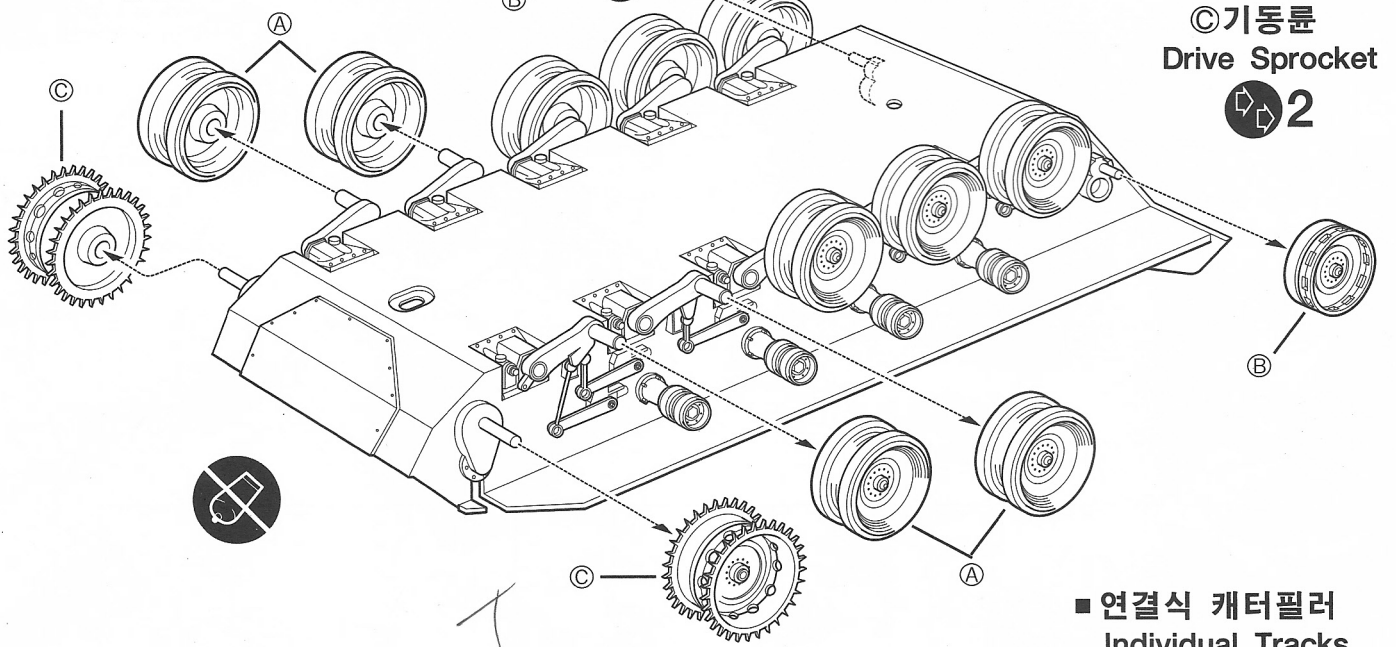

■ 연결식 캐터필러 Individual Tracks

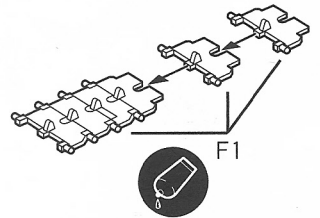

8

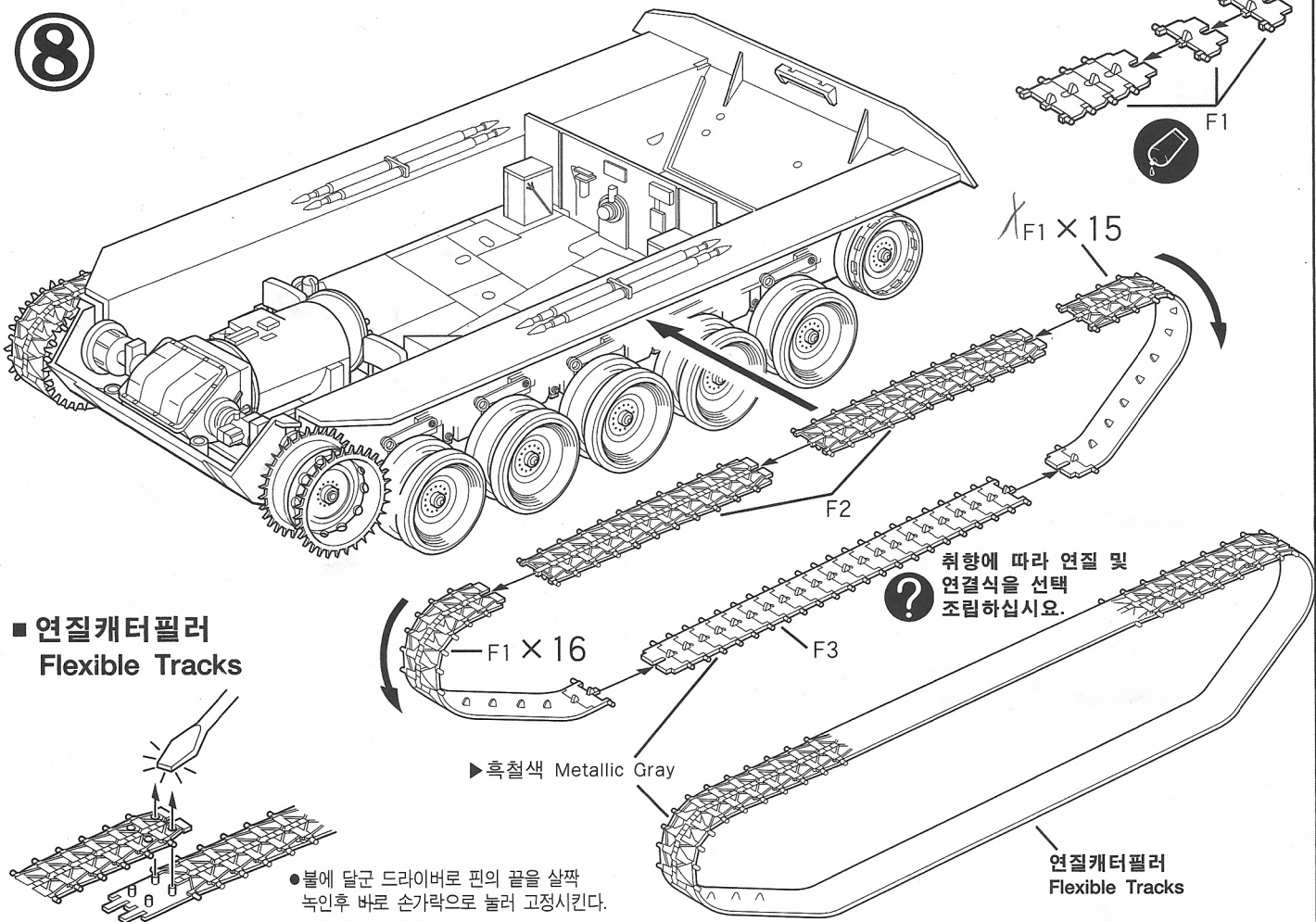

■ 연결캐터필러 Flexible Tracks

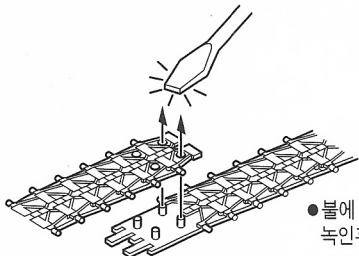

● 볼에 달근 드라이버로 핀의 끝을 살짝 녹인후 바로 손가락으로 눌러 고정시킨다.
Melt pins heated screwdriver

취향에 따라 연결 및 연결식을 선택
조립하십시오.

▶ 흑철색 Metallic Gray

연결캐터필러 Flexible Tracks

9

▶ 차체내부 Hull Interior: 무광백색 Flat White

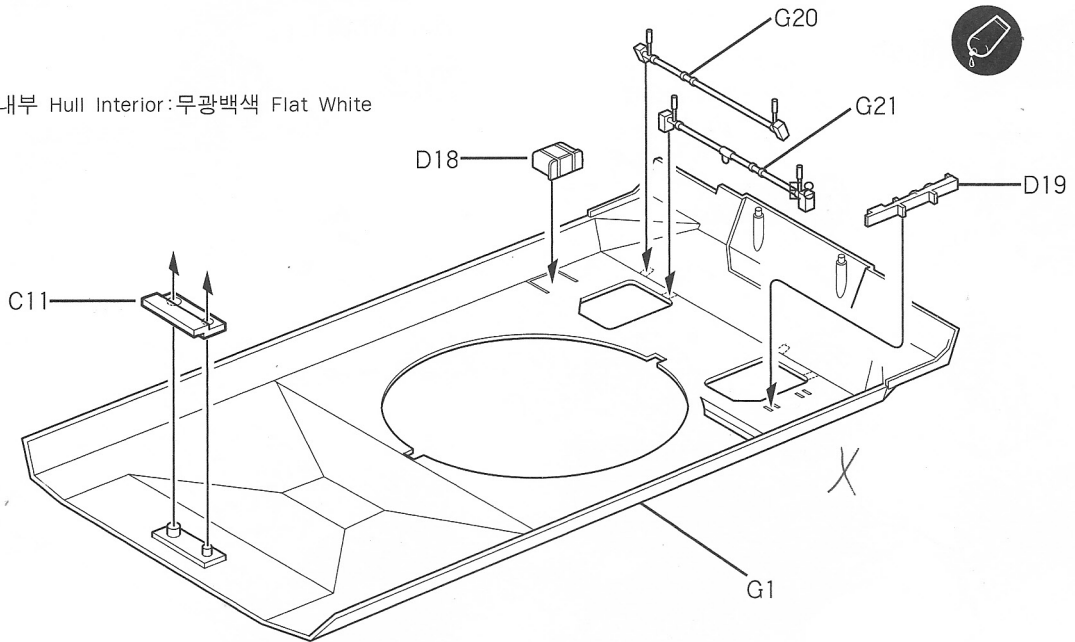

10

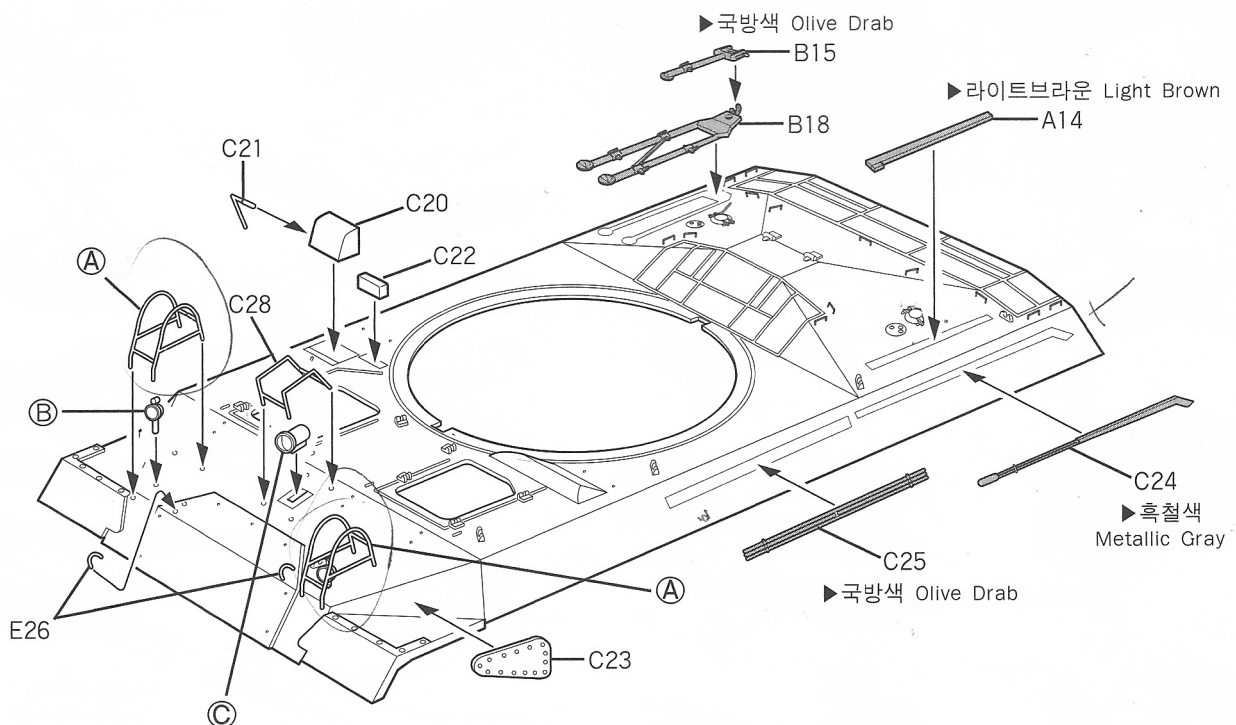
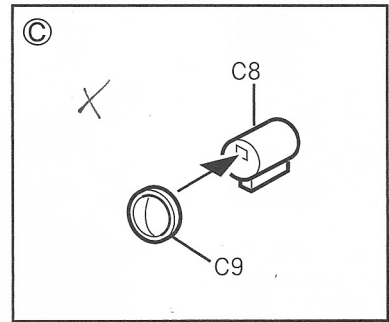
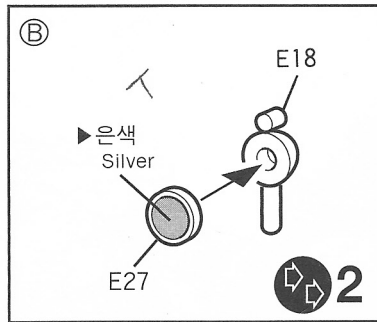
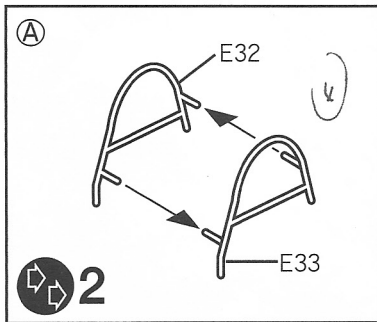

11

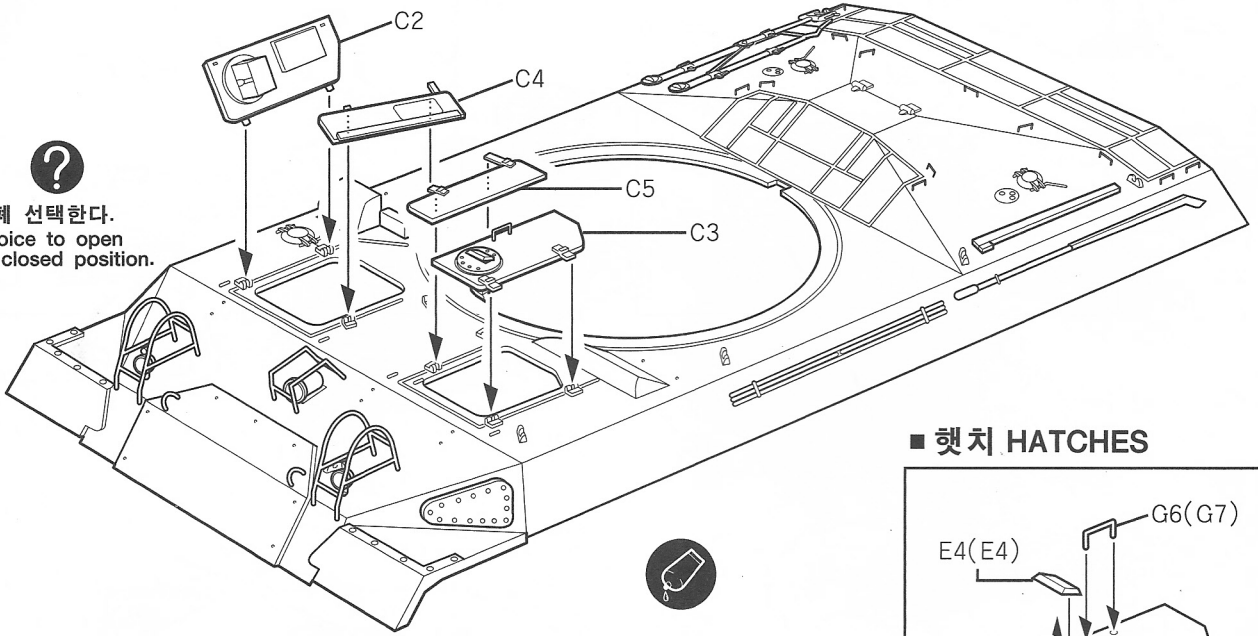

개폐 선택한다.
Choice to open
or closed position.

■ 햇치 HATCHES

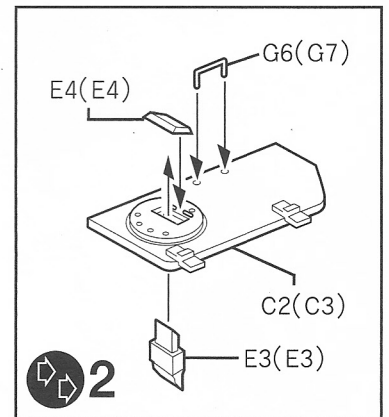

12

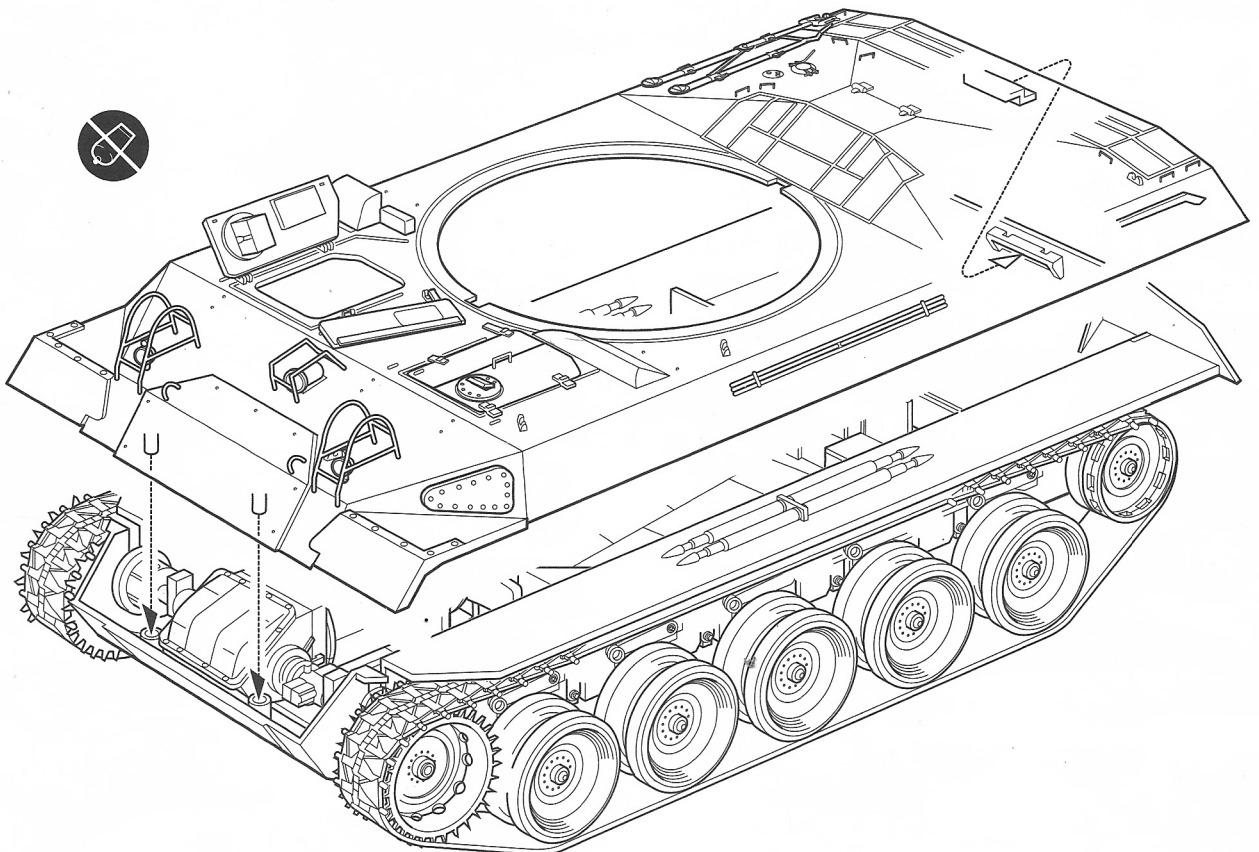

13

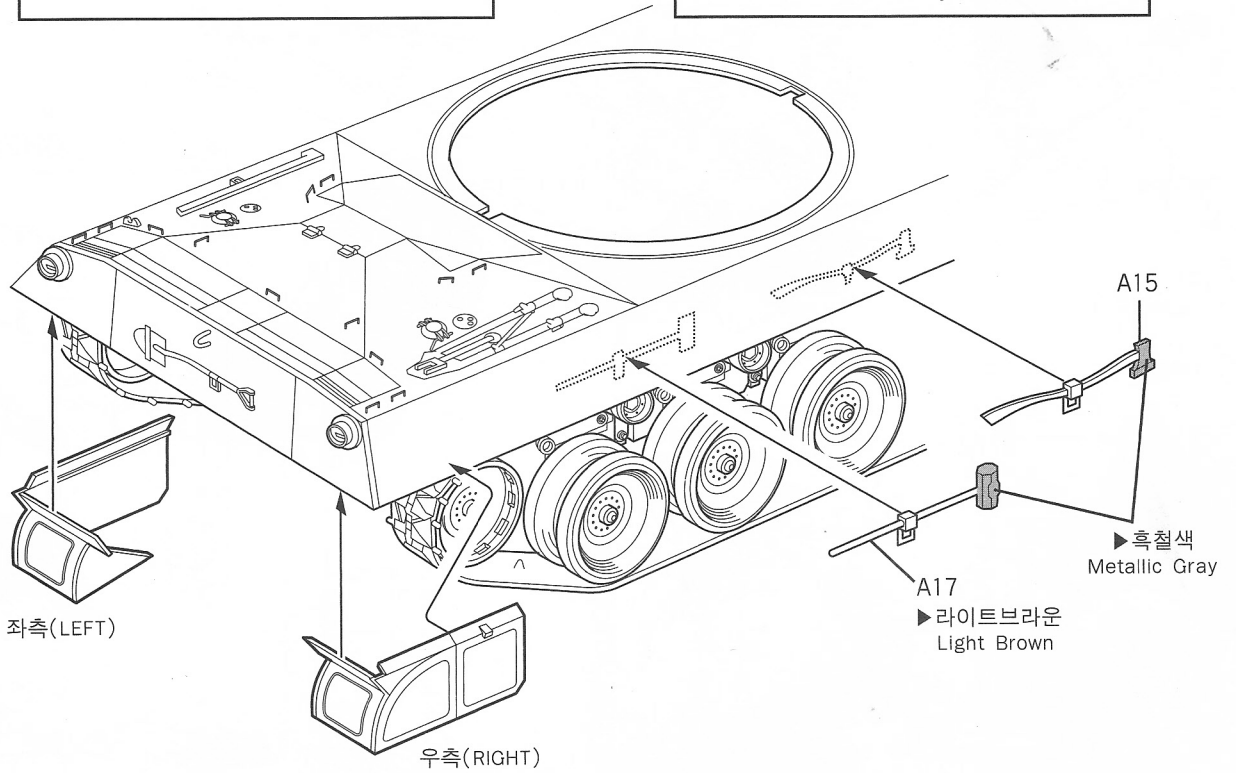
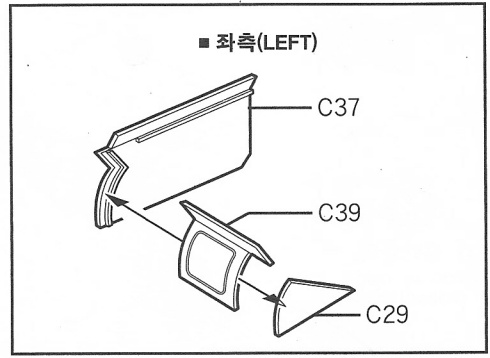
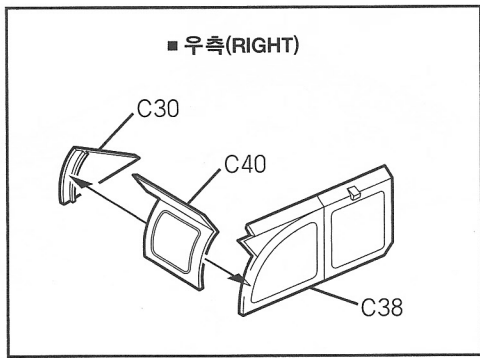

14

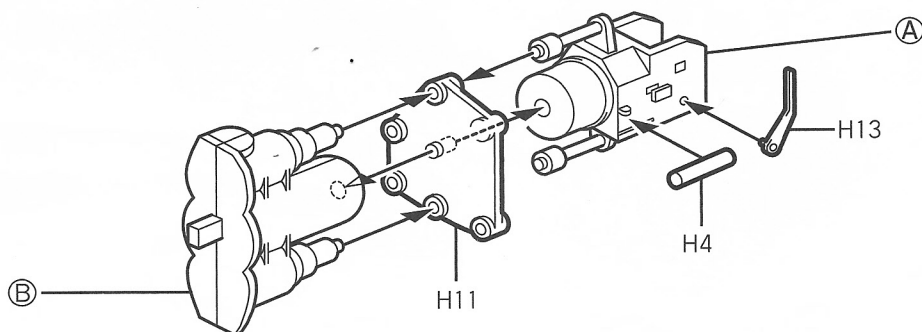
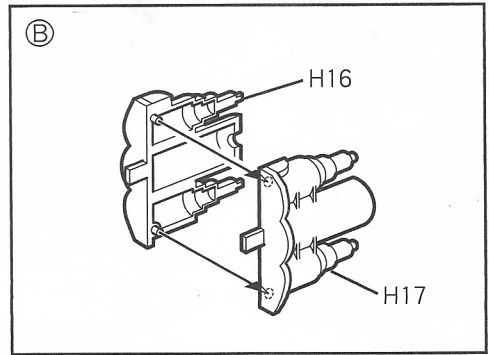
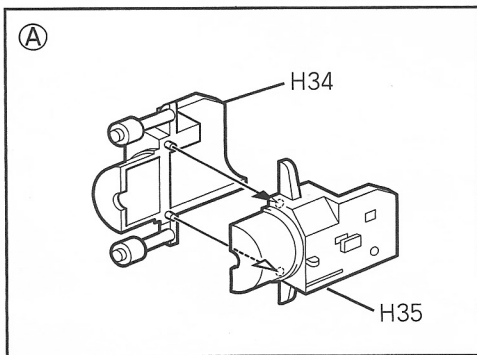

15

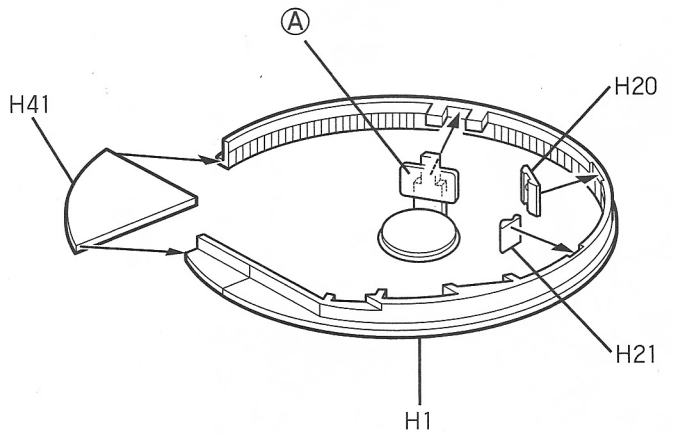
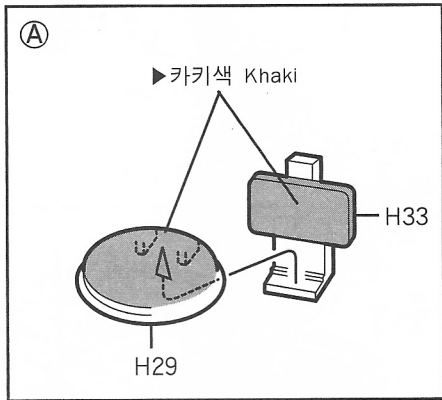
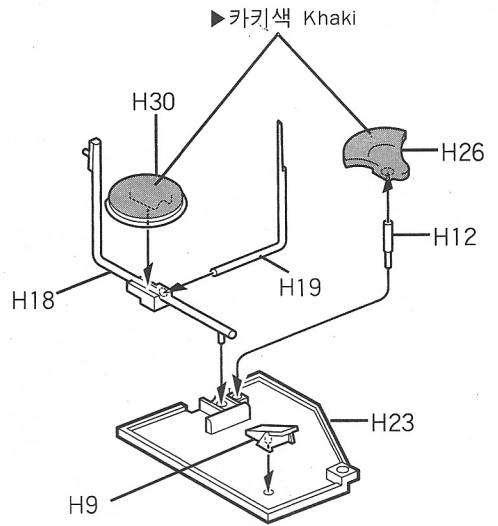
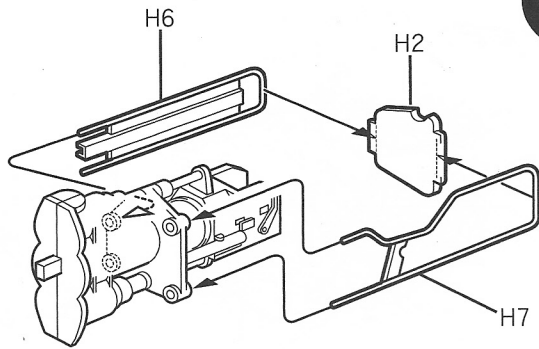

16

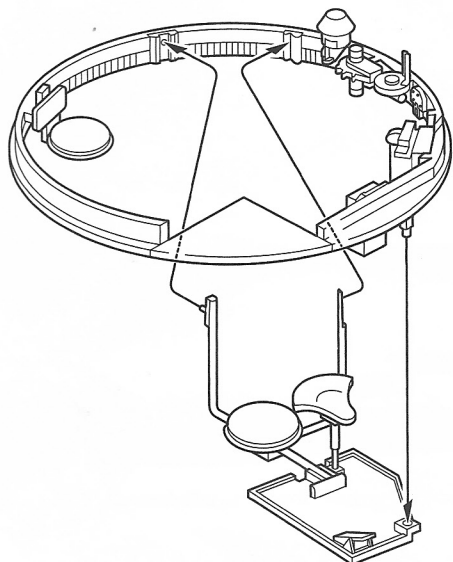
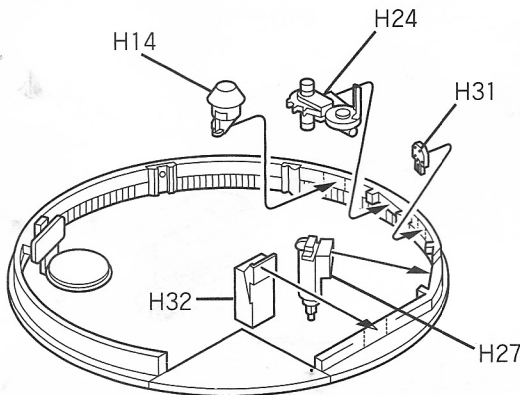

▶전체: 국방색
Overall: Olive Drab

17

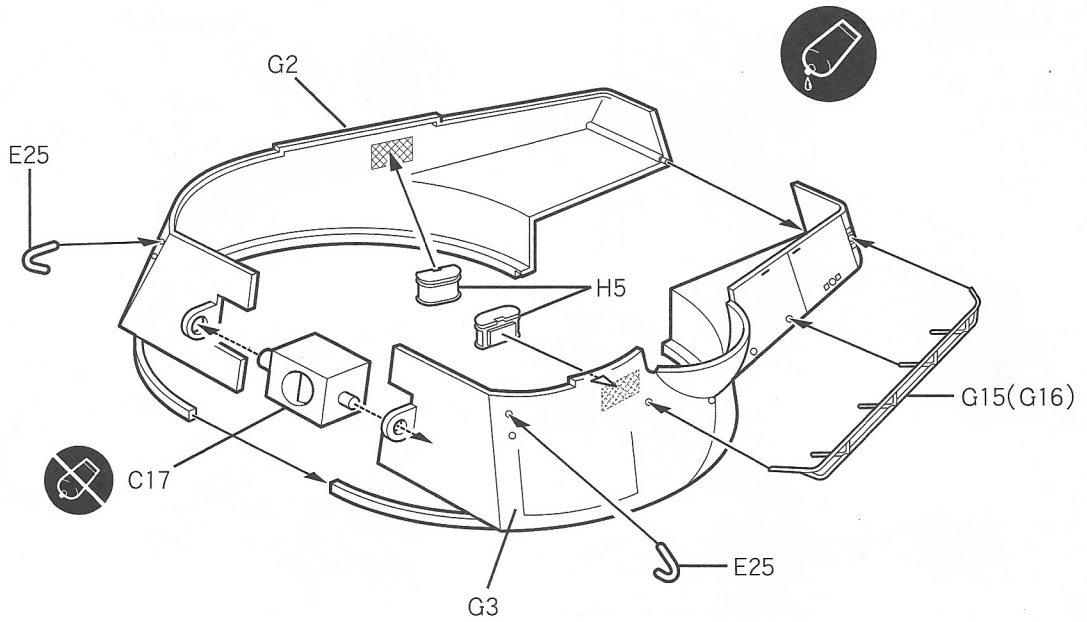

18

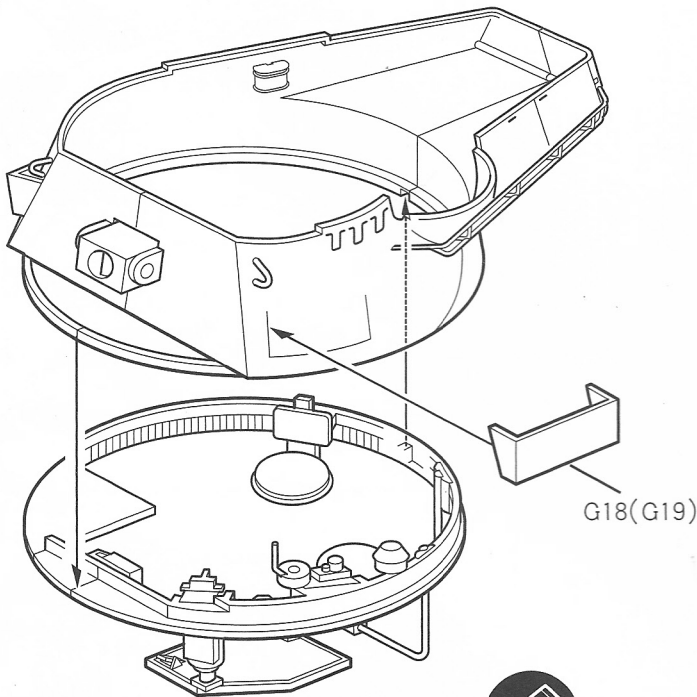

■ 무전기 RADIO

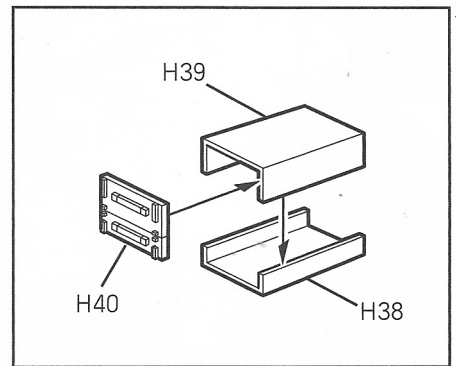

선택 조립한다.

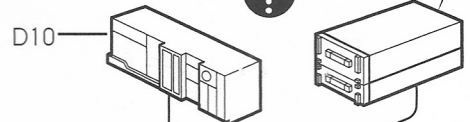

▶ 포탑내측: 국방색
Turret Interior: Olive Drab

▶ 카키색 Khaki

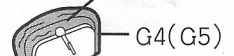

19

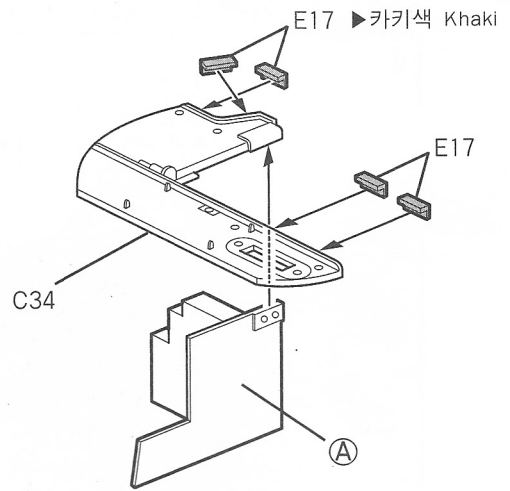
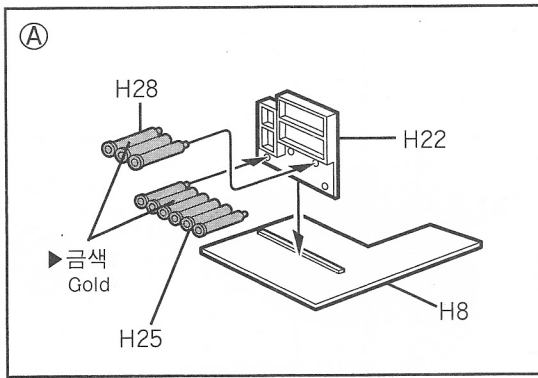

20

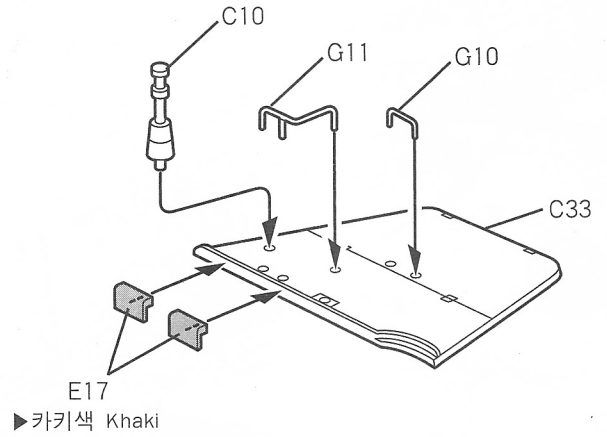
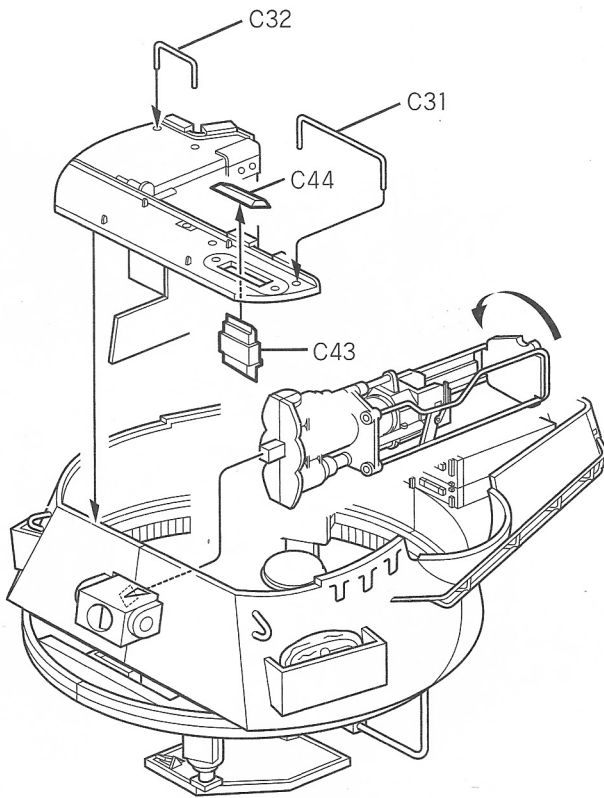

21

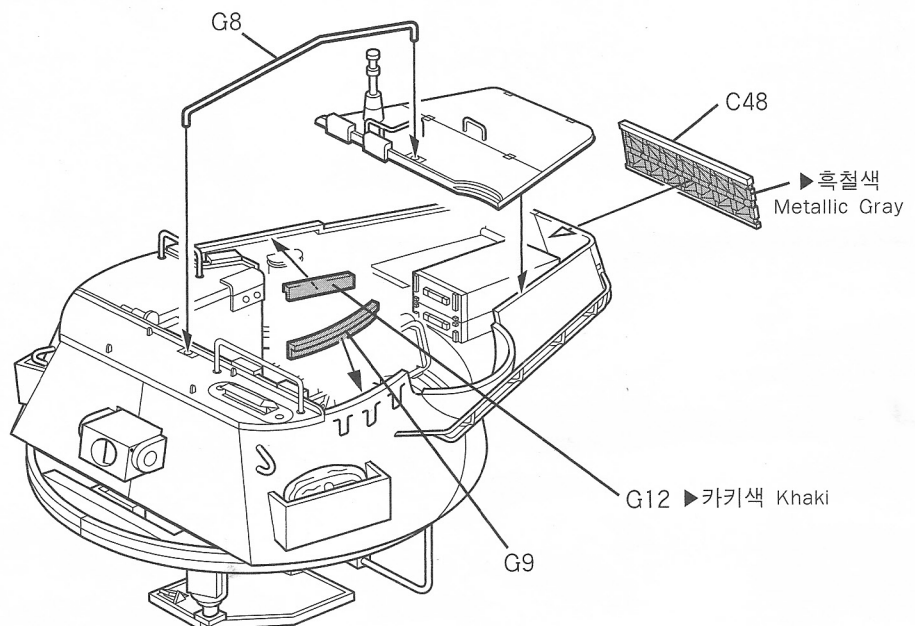

22

■ CAL.50 기관총 CAL.50 MG

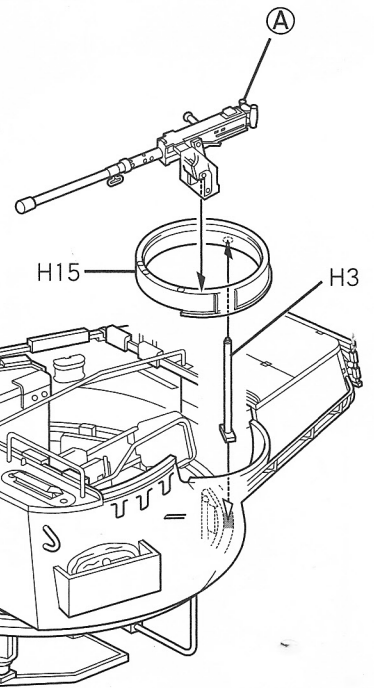
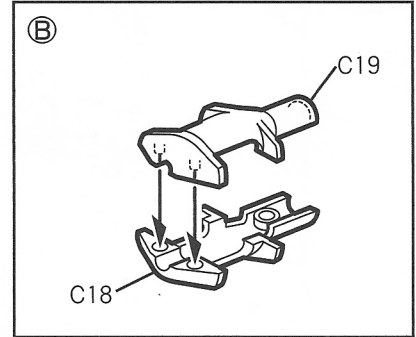
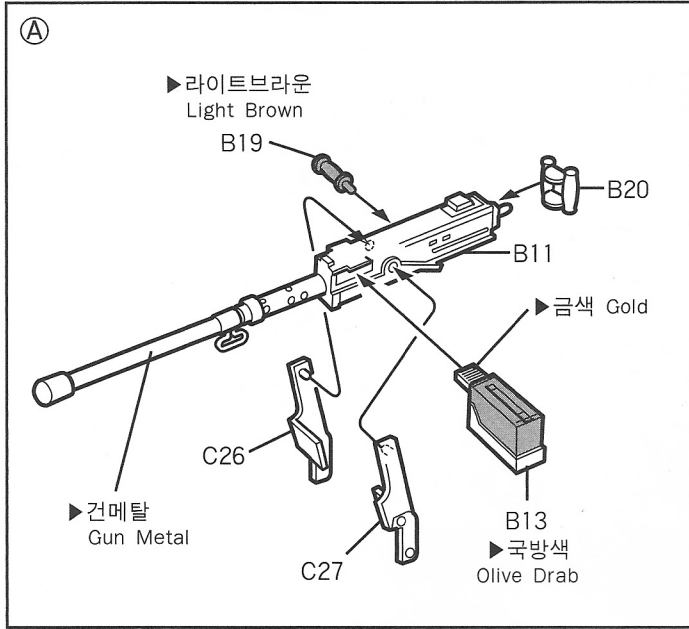

23

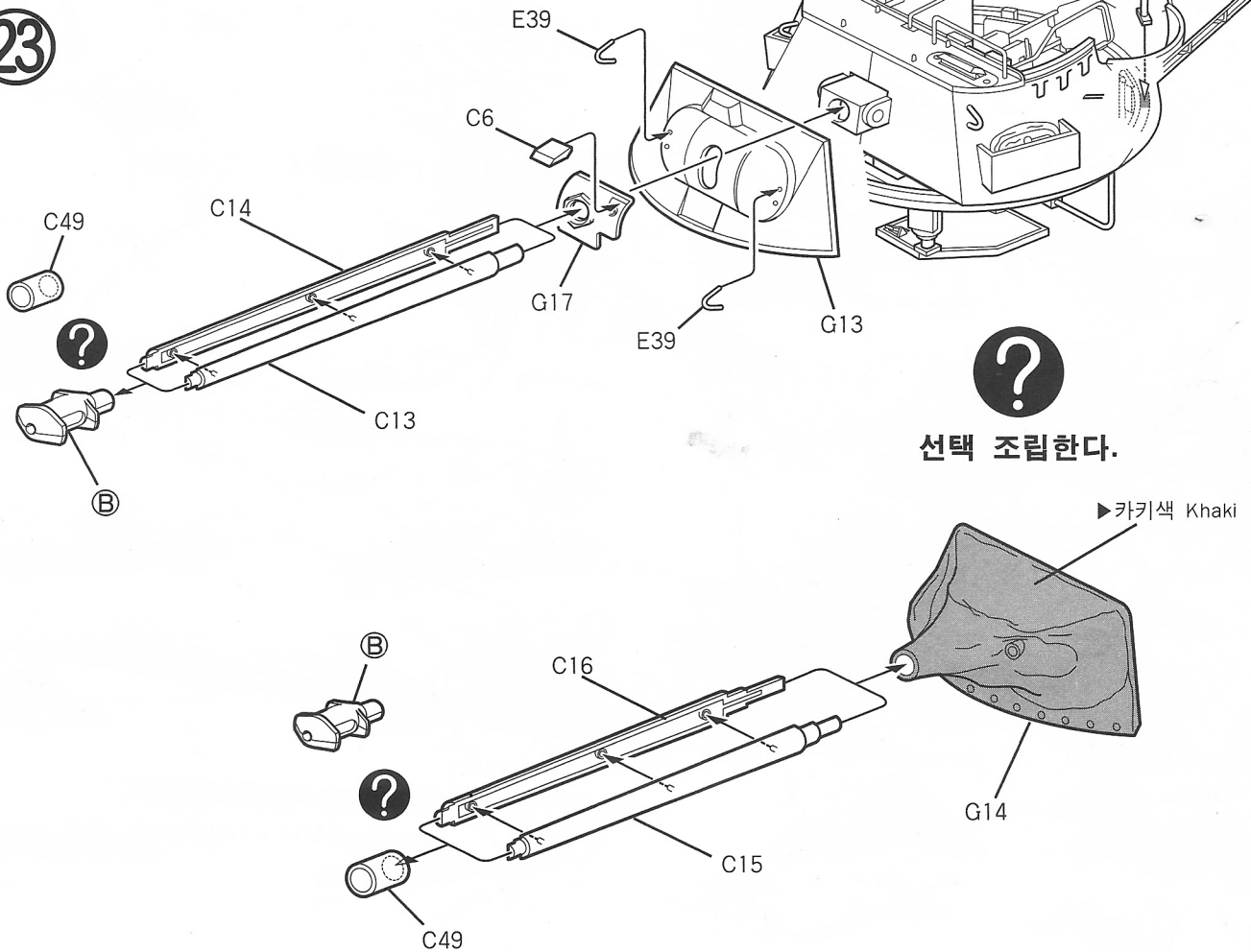

선택 조립한다.

24

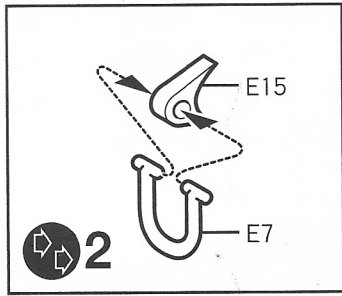

■ 후크 ㉠ HOOK ㉠



선택 조립한다.

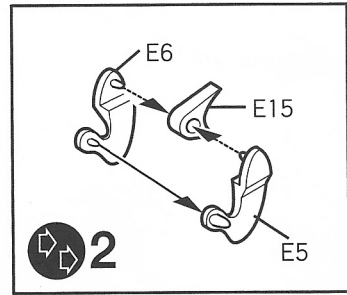

■ 후크 ㉡ HOOK ㉡

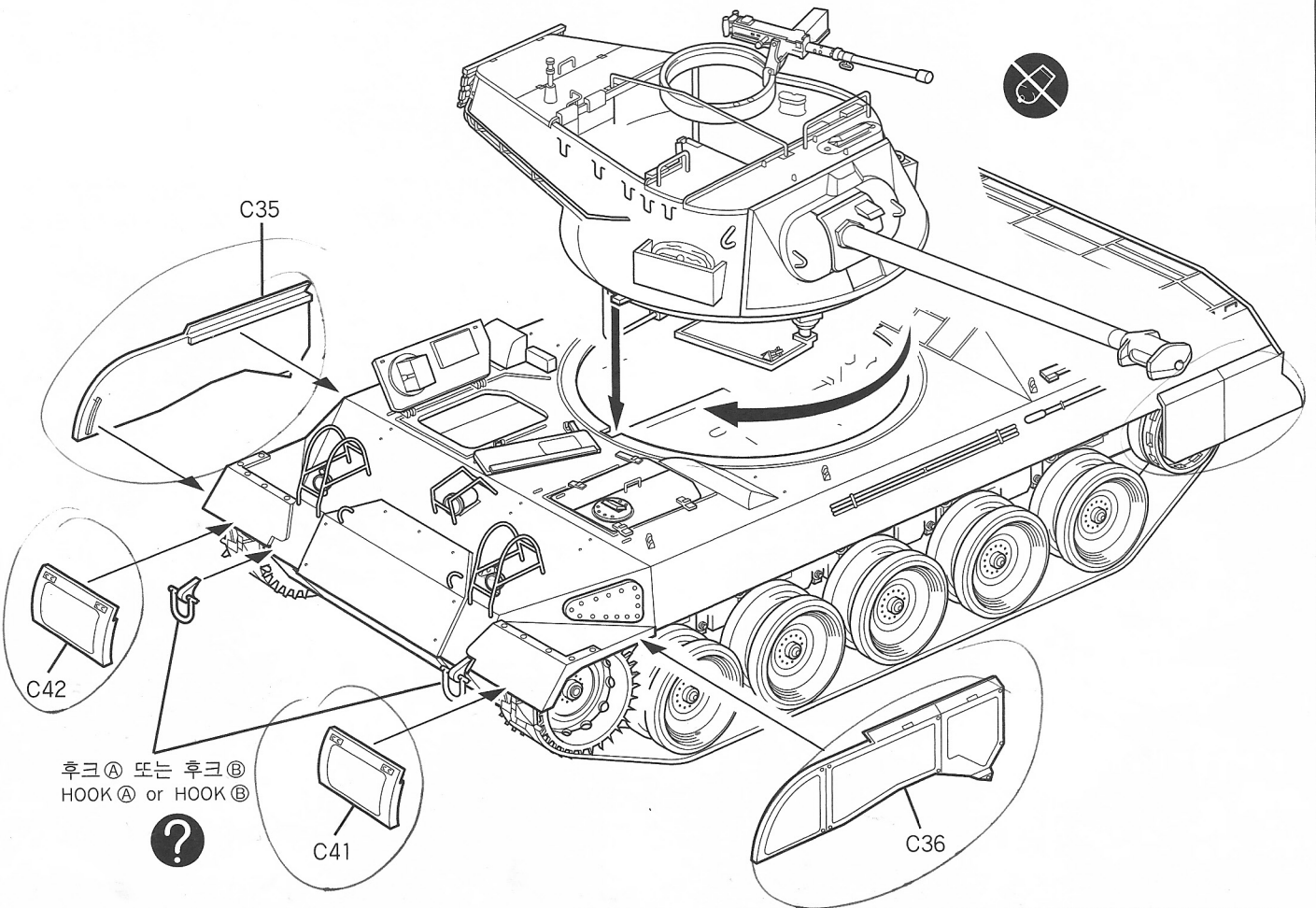

후크 ㉠ 또는 후크 ㉡
HOOK ㉠ or HOOK ㉡

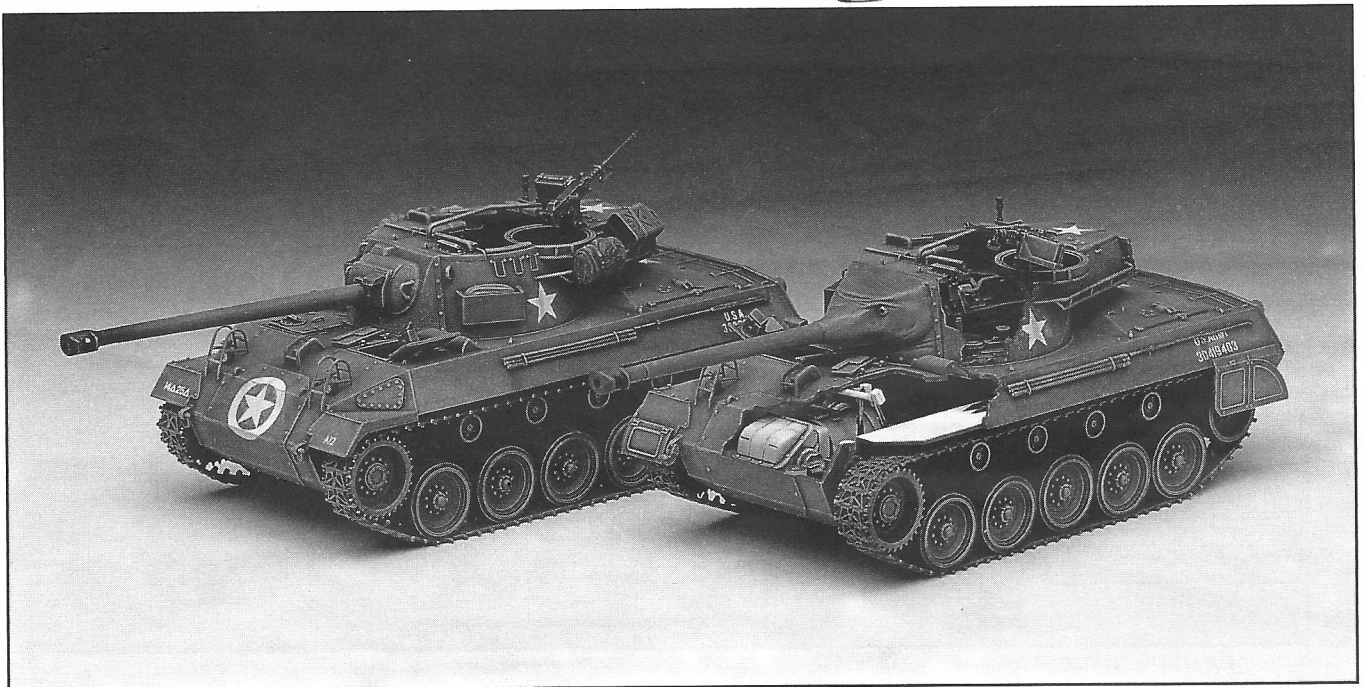

25

■ 75mm 탄약상자
75mm AMMO BOX

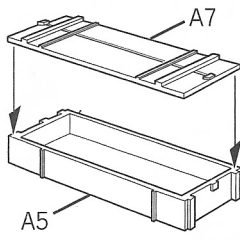

■ 76mm 탄약상자
76mm AMMO BOX

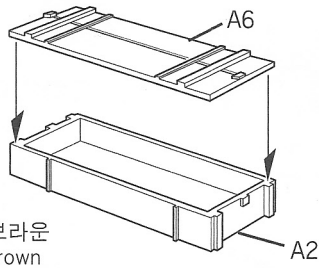

▶ 라이트브라운
Light Brown

■ 제리칸 JERRY CAN

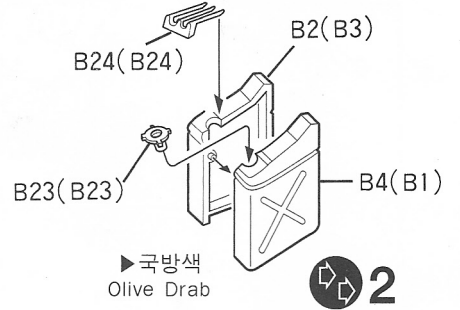

▶ 국방색
Olive Drab

2

■ 견인고리
TOWING HOOK

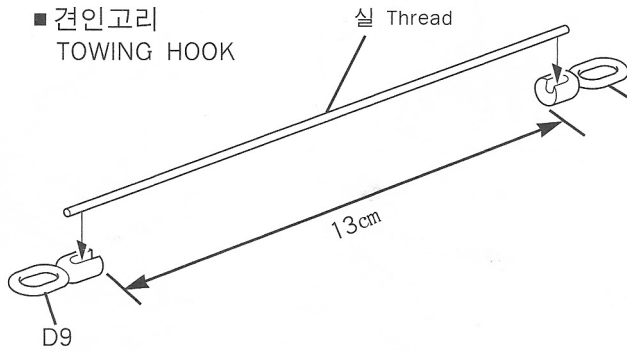

■ CAL.50 탄약상자
CAL.50 AMMO BOX

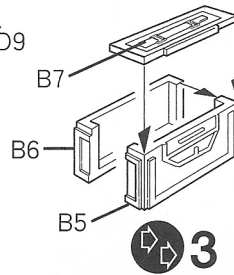

3

■ CAL.30 탄약상자
CAL.30 AMMO BOX

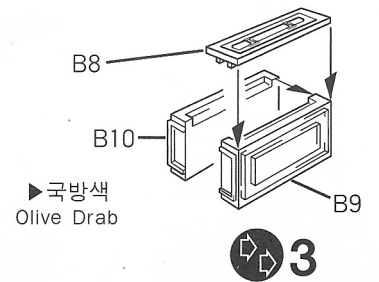

▶ 국방색
Olive Drab

3

■ 탄약케이스 AMMO TUBES

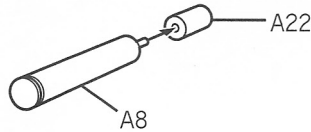
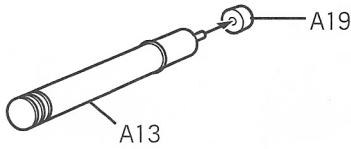

▶ 무광검정 또는 국방색
Flat Black or Olive Drab

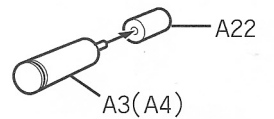

※ 남은 악세서리는 자유롭게 붙인다. Use Extra Accessories as you Like.

색칠 및 전사지 붙이기(Painting and Decal Placement)

■ 1944년 9월 프랑스 France on September 1944

■ 차체색:국방색
Body Color:Olive Drab

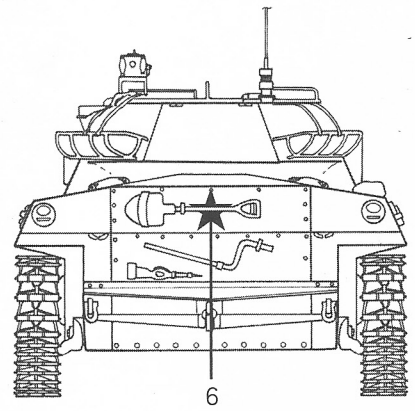
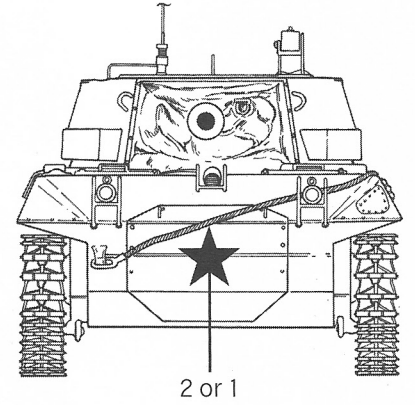
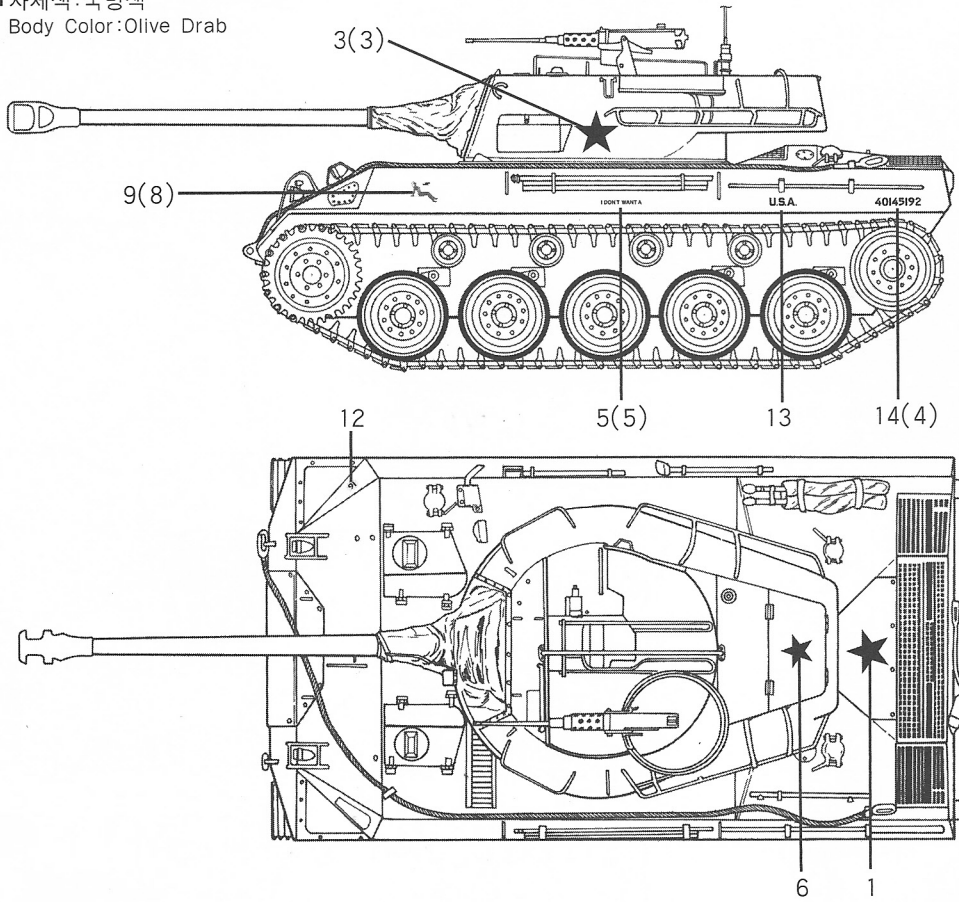

■ 1944년 12월 독일 Germany on December 1944

■ 차체색:국방색
Body Color:Olive Drab

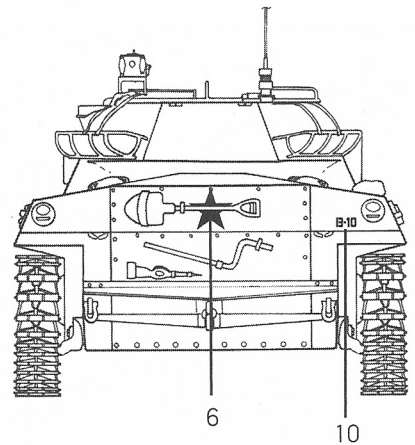
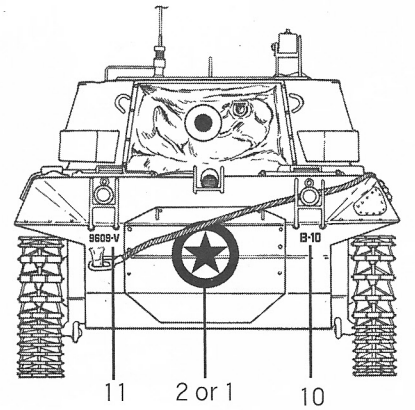
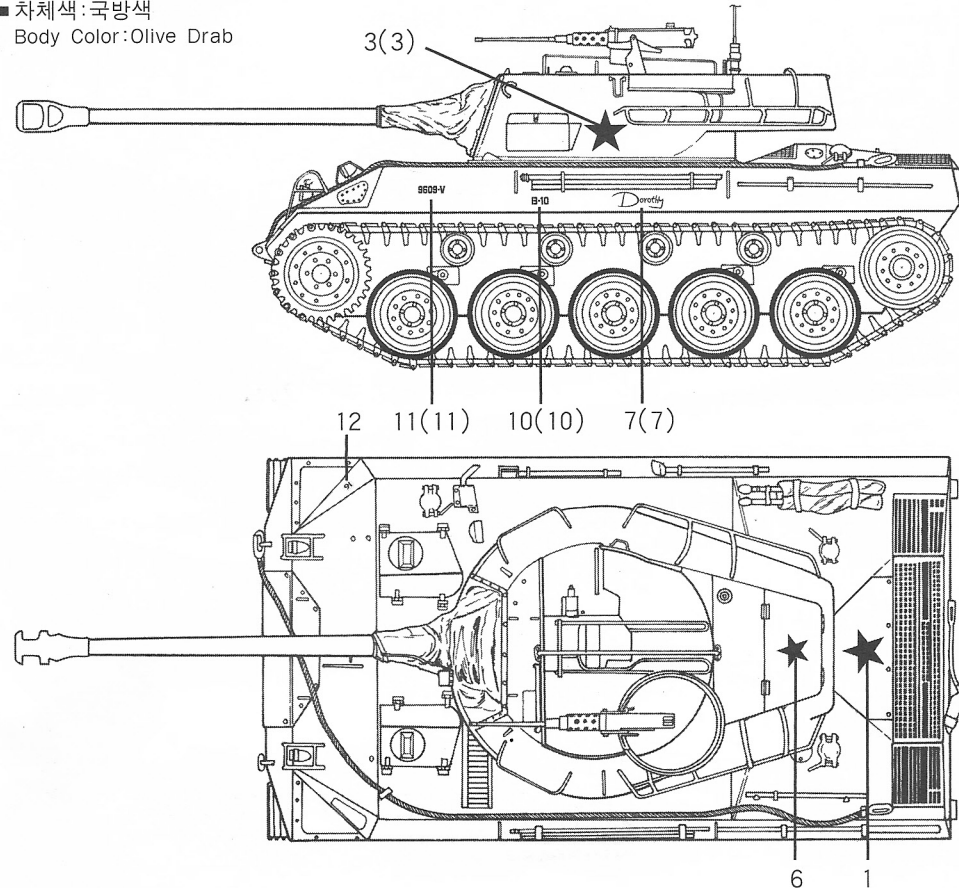

부품도 Parts Locating Diagram

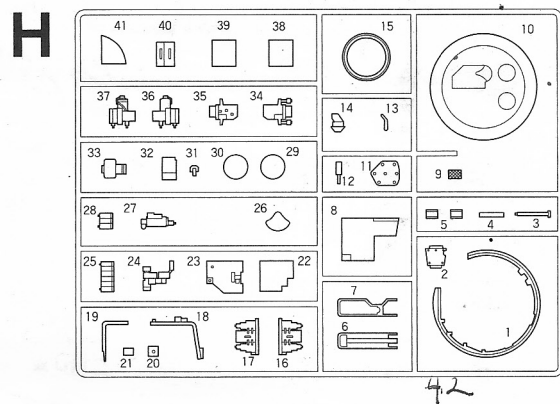
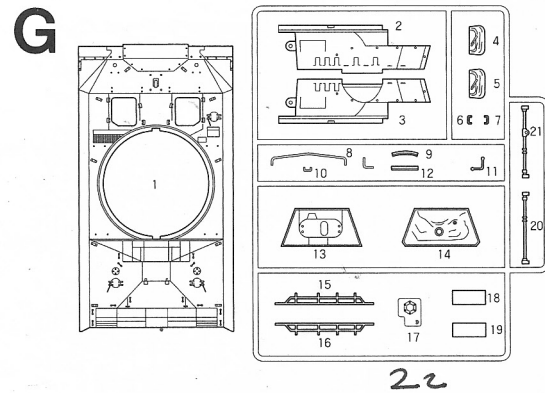
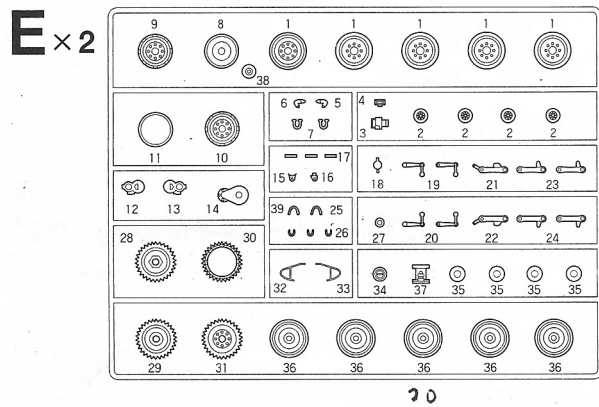
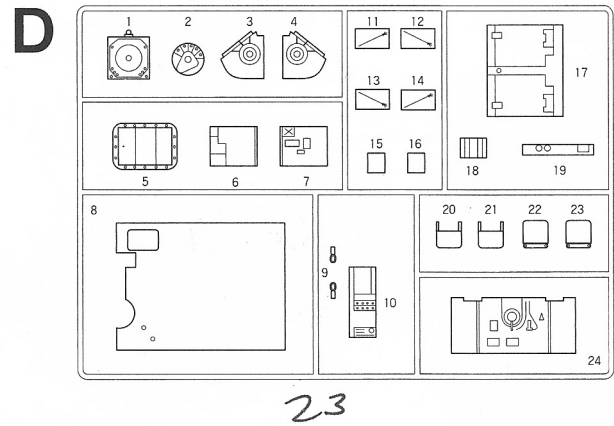
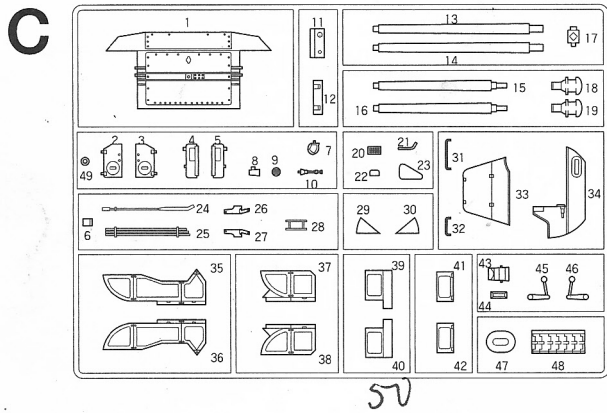
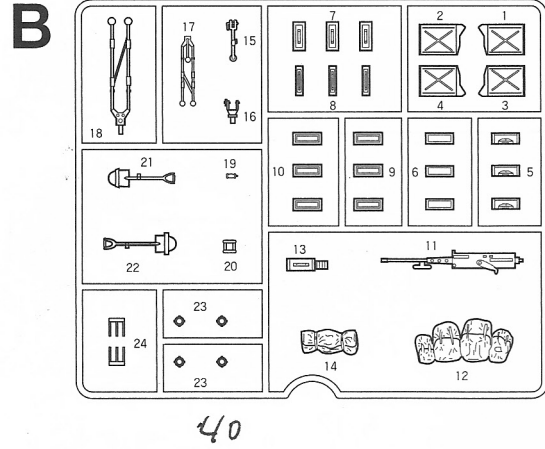
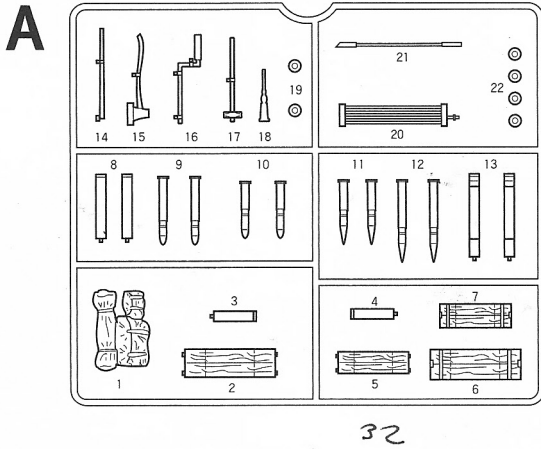

- 하체 Lower Hull × 1
- 연질캐터필러 Flexible Track × 2
- 연결식캐터필러 (F부품) Individual Tracks (F part) × 2
- 실 Thread × 1
- 폴리부품 Poly Cap × 1
- 전사지 Decal × 1
- ※ 불필요부품 Unused Parts
E21 × 1, E22 × 1, E28, E31, H10, C47

ACADEMY (주) 아카데미과학
ACADEMY PLASTIC MODEL CO., LTD.
 HOBBY MODEL KITS 273-64, Suyu-dong, Kangbuk-gu, Seoul, Korea FAX: 82-2-997-3003